

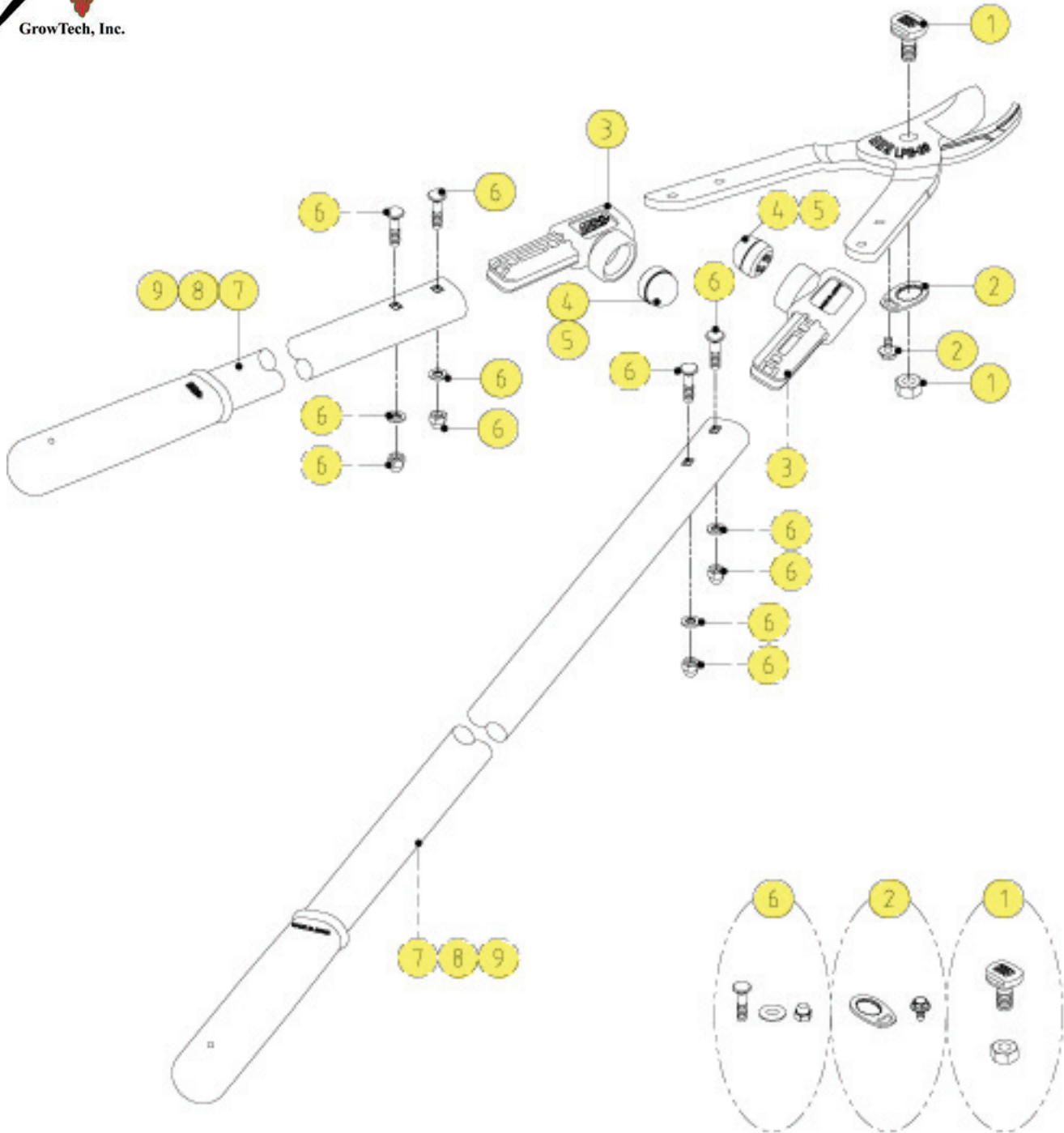

# LPB-20/30 ARS LOPPERS



1. **SP-LPB288** Center Bolt & Nut
2. **SP-LPB426** Screw Retainer Set
3. **SP-LPB419** Bumper Socket Set (1 pc.)
4. **SP-LPB420** Shock Absorber Set for LPB-20S/30S (1 pc.)
5. **SP-LPB421** Shock Absorber Set for LPB-20M/L & LPB-30M/L (1 pc.)
6. **SP-LPB387** Blade Holding Bolt, Nut, & Washer (1 pc each)
7. **SP-LPB422** Pipe with Grip for LPB-20S/30S
8. **SP-LPB423** Pipe with Grip for LPB-20M/30M (1 pc)
9. **SP-LPB389** Pipe with Grip for LPB-20L/30L & LPA-30L (1 pc)

## BLADE SETS:

- |                  |                               |
|------------------|-------------------------------|
| <b>SP-LPB201</b> | Cutting Blade for LPB-20S/M/L |
| <b>SP-LPB202</b> | Counter Blade for LPB-20S/M/L |
| <b>SP-LPB301</b> | Cutting Blade for LPB-30S/M/L |
| <b>SP-LPB302</b> | Counter Blade for LPB-30S/M/L |